

# SENA



## **SRL-EXT**

MOTORCYCLE MESH & BLUETOOTH®  
COMMUNICATION SYSTEM FOR SHOEI HELMETS

———— SOUND BY ————  
**harman/kardon®**

QUICK START GUIDE

ENGLISH / 1.0.0

## Downloadable Sena Software

Download the **SENA MOTORCYCLES App** on **Google Play Store** or **App Store**.



### SENA MOTORCYCLES

- Device Configuration Setting

Download the following items at [sena.com](http://sena.com).



### Firmware



### Sena Device Manager

- Firmware upgrade
- Device configuration setting



### Quick Start Guide, User's Guide

Follow us on Facebook, YouTube, Twitter and Instagram to check the latest information and helpful tips.

**SENA**



SENA Technologies, Inc.  
Customer Support: [sena.com](http://sena.com)

## Product Details

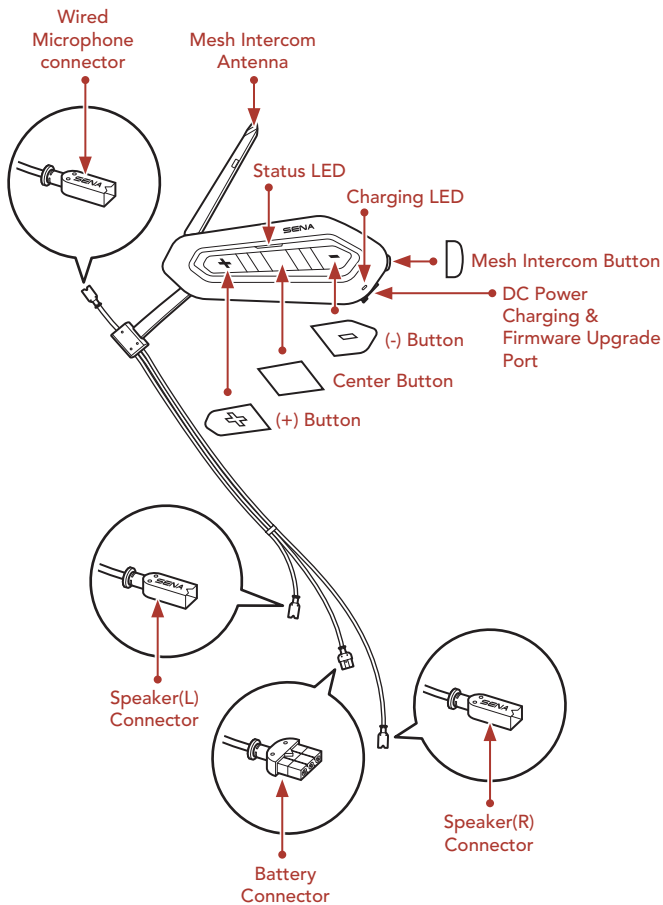

## Installation

The **SHOEI's RF-1400 Helmet** is compatible with the **SRL-EXT**.

The model name of the **RF-1400 Helmet** varies depending on the region.

- **RF1400(US), NXR 2(EU), Z-8(JP)**
- For more information about installation, refer to the User's Guide.

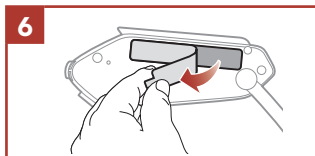
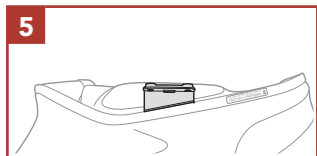
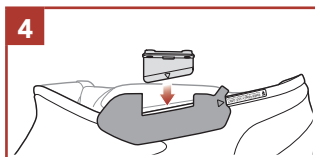
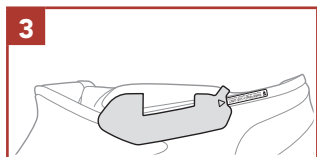
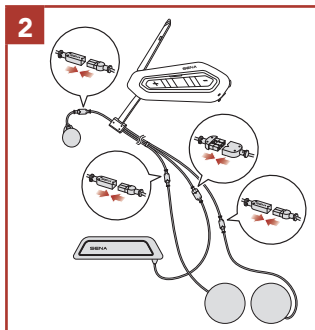
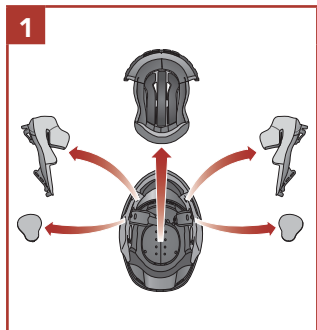

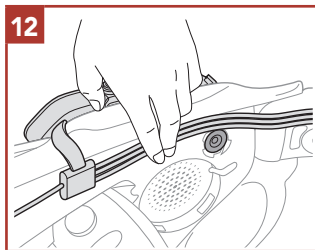
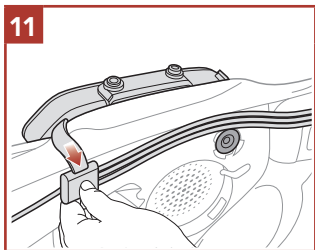
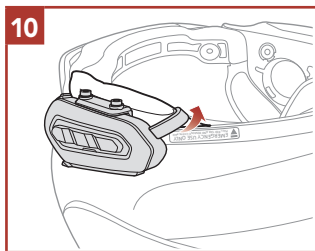
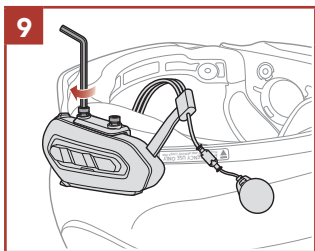
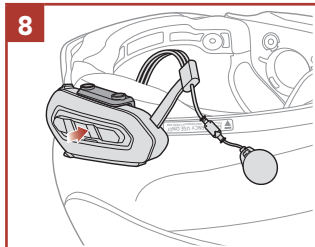
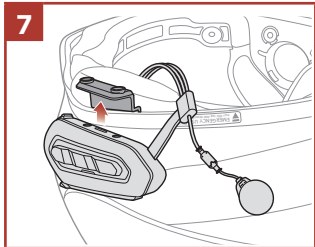

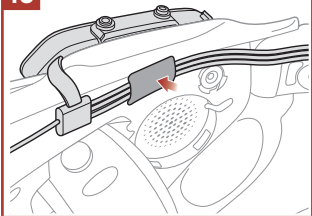
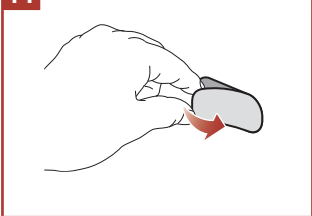
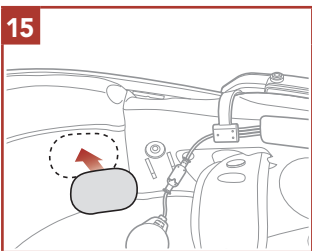
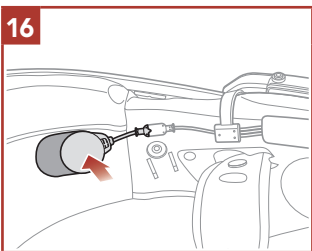
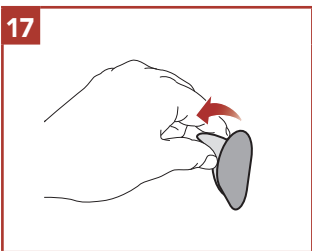
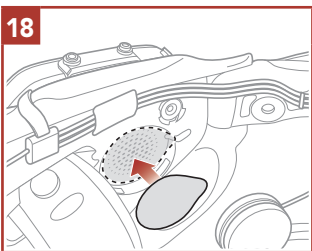
**13****14****15****16****17****18**

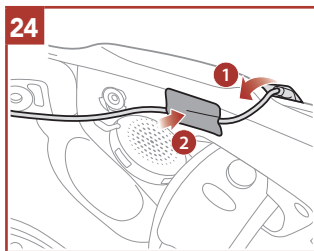
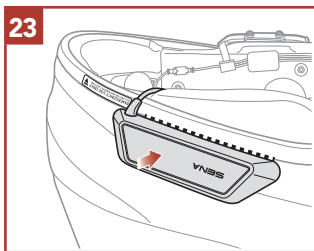
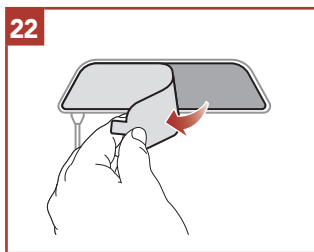
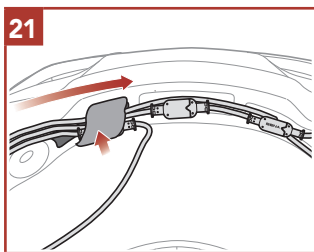
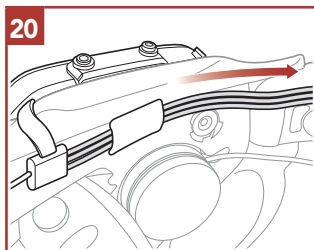
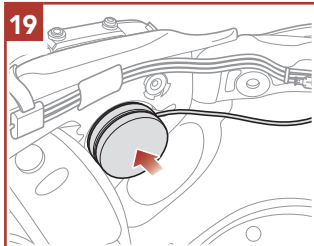

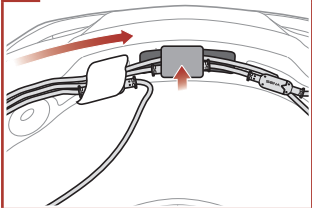
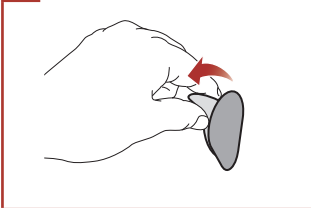
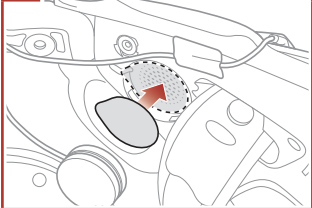
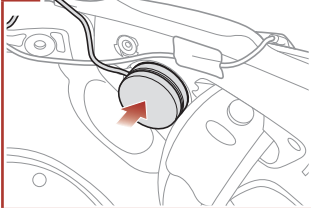
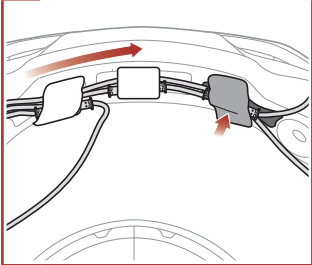
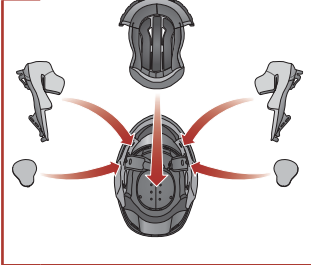
**25****26****27****28****29****30**



## Mesh Intercom Antenna

Pull the Mesh Intercom Antenna inwards slightly to unfold it.



## Icon Legend

**TAP 1x** Tap button the specified number of times

**HOLD 10s** Press and Hold button for the specified amount of time



"Hello"

Audible prompt

## Basic Operations

Powering On



Powering Off



Volume Up



Volume Down



## ■ Checking the Battery Level

Powering On



## ■ Phone Pairing



"Configuration menu"



Blinking  



"Phone pairing"

- ③ Select **SRL-EXT** in the list of Bluetooth devices detected.



- For more information on phone pairing, refer to the User's Guide.

## Using the Phone

### Answer a Call



### End a Call



### Reject a Call



## Siri and Google Assistant

### Activate the Siri or Google Assistant Installed on Your Phone



"Hey Google"  
or "Hey Siri"

or



## Music Control

### Play/Pause



### Track Forward



### Track Backward



## ■ Mesh Intercom™

**Open Mesh™:** communication within the same channel.

**Group Mesh™:** communication within the same private group.

- For more information on **Mesh Intercom**, refer to the User's Guide.

### Mesh Intercom On



TAP  
1x



Blinking 



"Mesh intercom on,  
Open Mesh, channel 1"

### Mesh Intercom Off



TAP  
1x



"Mesh intercom off"

**Note:** When **Mesh Intercom** is on, the **SRL-EXT** will automatically connect to nearby **SRL-EXT** users and the headset will be in **Open Mesh** (default: channel 1) initially.

# Open Mesh

## Channel Setting (Default: channel 1) in Open Mesh

- ① Enter into the **Channel Setting**.



- ② Navigate between channels.  
(1 → 2 → ... → 8 → 9 → Exit → 1 → ...)



- ③ Save the channel.



**Note:** You can use the **SENA MOTORCYCLES App** to change the channel.

# Group Mesh

**Group Mesh** is a closed group intercom function that allows users to join, leave, or rejoin a group intercom conversation without pairing each headset.

## 1) Creating a Group Mesh

Creating a **Group Mesh** requires **two or more Open Mesh users**.

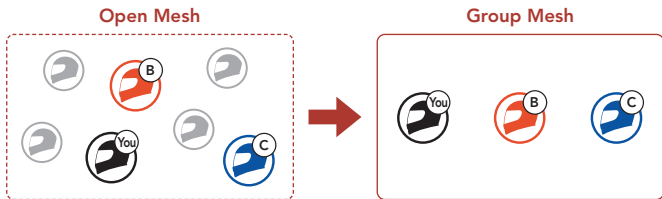

- ① **Users (You, B, and C)** enter into **Mesh Grouping** to create a **Group Mesh**.



- ② When **Mesh Grouping** is completed, the **users (You, B and C)** will hear a voice prompt on their headsets as **Open Mesh** switches to **Group Mesh**.



## 2) Joining an Existing Group Mesh

One of the **current users** in an **Existing Group Mesh** can allow **new users (one or more)** in **Open Mesh** to join the **Existing Group Mesh**.

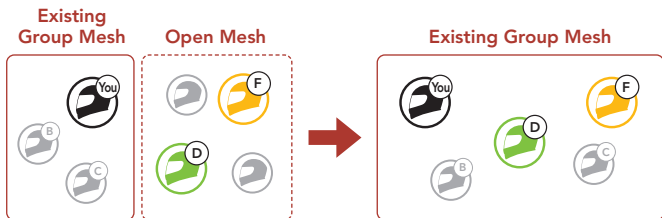

- ① **One (You) of the current users** in the **Existing Group Mesh** and **new users (D and F)** in **Open Mesh** enter into **Mesh Grouping** to join the **Existing Group Mesh**.



- ② When **Mesh Grouping** is completed, the **new users (D and F)** will hear a voice prompt on their headsets as **Open Mesh** switches to **Group Mesh**.



## ■ Enable/Disable Mic (Default: Enable)

Users can enable/disable the microphone when communicating in a **Mesh Intercom**.



## ■ Reset Mesh

If the headset in an **Open Mesh** or **Group Mesh** resets the **Mesh**, it will automatically return to **Open Mesh (default: channel 1)**.



## ■ Bluetooth Intercom

Up to three other people can be paired with the headset for Bluetooth intercom conversations.

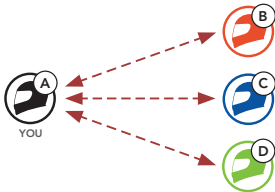





## Intercom Pairing

There are two ways to pair the headset.

### Using the Smart Intercom Pairing (SIP)

**SIP** allows you to quickly pair with your friends for intercom communication by scanning the QR code on the **SENA MOTORCYCLES App** without remembering the button operation.

- ① Pair the mobile phone with the headset.
- ② Open the **SENA MOTORCYCLES App** and tap  (**Smart Intercom Pairing Menu**).
- ③ Scan the **QR code** displayed on your friend (**B**)'s mobile phone.
  - Your friend (**B**) can display the QR code on the mobile phone by tapping  > **QR code** () on the **SENA MOTORCYCLES App**.

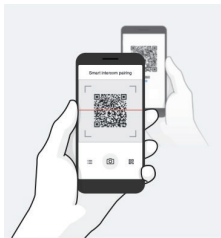

- ④ Tap **Save** and check that your friend (**B**) is paired with **you (A)** correctly.
- ⑤ Tap **Scan** () and repeat steps 3-4 to pair with **Intercom Friends (C)** and **(D)**.

**Note:** The **Smart Intercom Pairing (SIP)** is not compatible with Sena products that use **Bluetooth 3.0** or **below**.

## Using the Button



- ① **Users (You, B)** enter into **Intercom Pairing**.



Blinking 

 "Intercom pairing"

- ② The **two headsets (A and B)** will be automatically paired.



Turns blue 



- ③ Repeat the steps above to pair with **other headsets (C and D)**.

## ■ Last-Come, First-Served

If the headset has multiple paired headsets for intercom conversations, the last paired headset is set as the **First Intercom Friend**.

### Intercom Pairing Order

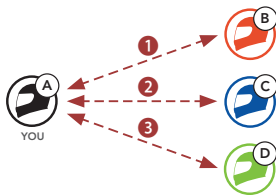

### Last-Come, First-Served



## Two-way Intercom

Start/End Conversation with the First Intercom Friend D



Start/End Conversation with the Second Intercom Friend C

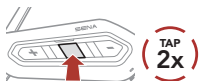

Start/End Conversation with the Third Intercom Friend B



## FM Radio

### FM Radio On/Off



### Start/Stop Scanning



### Seek Forward



### Seek Backward



### Navigating Preset Stations

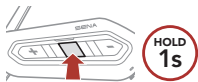

**Note:** You can also save the current station from the **SENA MOTORCYCLES App**.

# Configuration Menu

## Accessing the Configuration Menu



## Navigating Between Menu Options

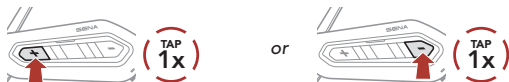

## Execute Menu Options



# Troubleshooting

## Fault Reset

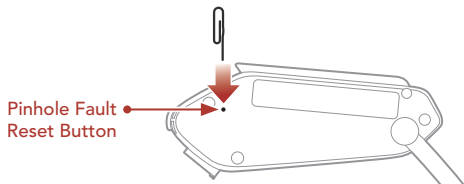





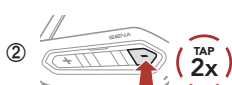





































**Note:** **Fault Reset** will not restore the headset to factory default settings.

## Factory Reset









-  →  "Configuration menu"
-  →  "Factory reset"
-  →  "Headset reset, good-bye"

## Quick Reference

TYPE	OPERATION	BUTTON COMMANDS
 Basic Operations	Power on / Power off	     
	Volume up / Volume down	 or  
 Mobile Phone	Answer phone call	 
	End phone call	 
	Reject phone call	 
 Siri and Google Assistant	Activate the Siri or Google Assistant	 

TYPE	OPERATION	BUTTON COMMANDS
 <p data-bbox="104 471 228 518">Mesh Intercom™</p>	Mesh Intercom on/off	 
	Channel setting	 
	Mesh Grouping	 
	Reset Mesh	 
	Enable/Disable Mic	 
 <p data-bbox="114 865 218 892">Intercom</p>	Intercom pairing	 
	Start/End intercom	 
 <p data-bbox="132 1143 200 1170">Music</p>	Play/Pause music	 
	Track forward	 
	Track backward	 



TYPE	OPERATION	BUTTON COMMANDS
 <p data-bbox="111 435 222 458">FM Radio</p>	FM radio on/off	 
	Select preset	 
	Seek forward/backward	 <span data-bbox="754 438 774 458">or</span>  
	Scan up FM band/ stop scanning	