

Shield Removal

1. Open the shield to its maximum open position. Do not force.
2. Grasp the shield, then pull it upward in the direction of the arrow, free of the base-plate channel.
3. The shield will be automatically released out of the base ratchet mechanism.

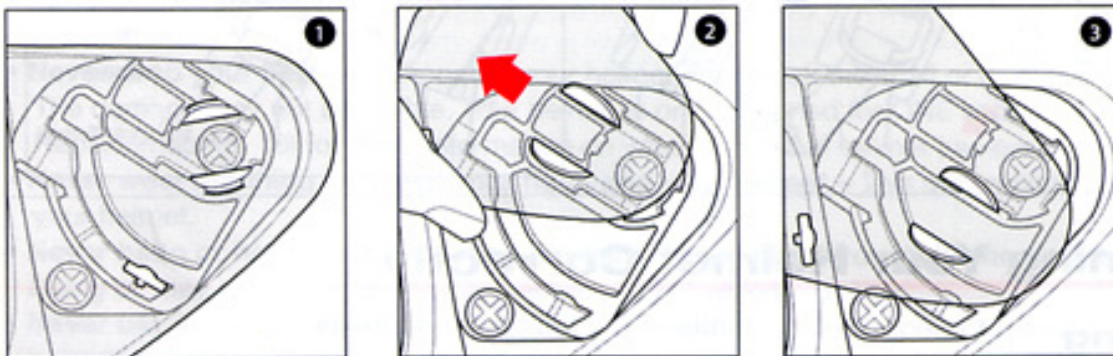

Shield Installation

1. Align the visor with the base-plate channel.
2. The shield should be in an open or upward position for proper alignment. The shield should slide within the base-plate channel to a full stop.
3. Close the shield.

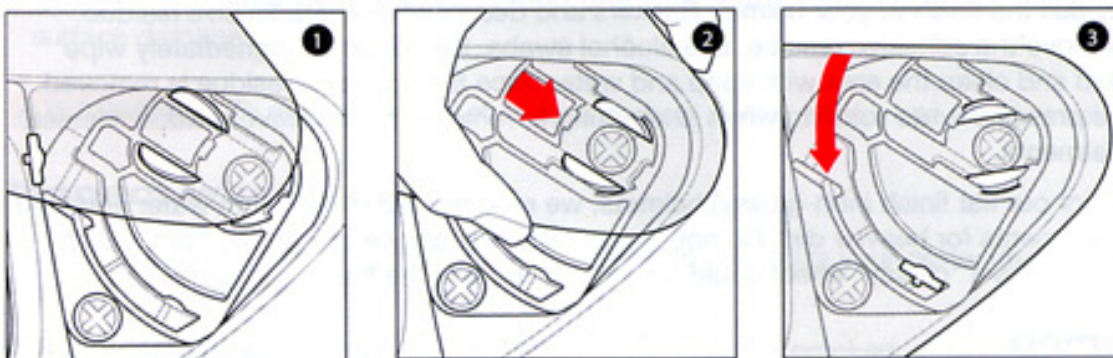

Visor Installation

1. Align the visor with the base-plate channel. The visor should be in an open or upwards position for proper alignment.
2. Slide the visor in the direction of the arrow within the base-plate channel to a full stop.

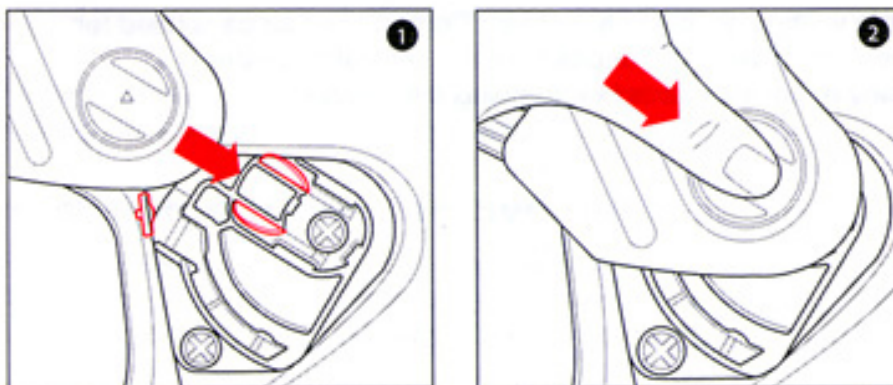

Visor Removal

1. Open the visor to its maximum open position. Do not force.
2. Grasp the visor, then pull it upward in the direction of the arrow, free of the base-plate channel.
3. The visor will be automatically released out of the base ratchet mechanism.

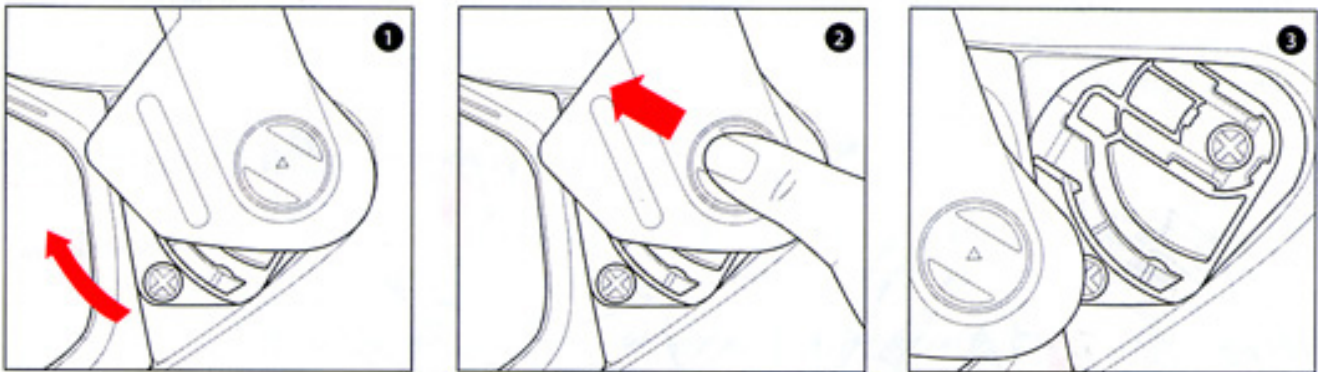

⚠WARNING Always check to make sure helmet pads are installed before using the helmet. A helmet with missing or improperly installed pads may increase your risk of serious injury or death in an accident.

Cheek Pad Removal

There are 2 snaps and a Velcro holding the cheek pad in place.

1. Gently pry the cheek pad's plastic sleeve away from the interior.
2. Grasp the cheek pad near its center and gently pull it free from the chin strap, releasing the snaps.

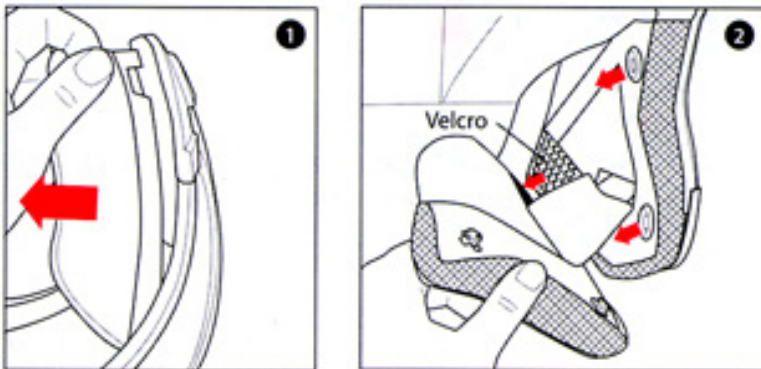

Cheek Pad Installation

1. Feed the chin straps through the opening in the cheek pad.
2. Force the cheek pad's plastic sleeve in between the shell and EPS.
3. Align 2 cheek pad snaps and Velcro, and press the snaps together, starting with Velcro first.

